

IIJS PREMIERE 2025 FLOOR PLAN (JWCC)

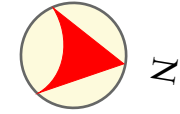

SECTION

- DIAMOND, GEMSTONE & OTHER STUDDED JEWELLERY
- GOLD & GOLD CZ STUDDED JEWELLERY
- LOOSE DIAMOND
- LABORATORIES & EDUCATION
- LABGROWN JEWELLERY
- LABGROWN DIAMOND (LOOSE)
- INTERNATIONAL
- PILLAR

SERVICE

- EMERGENCY EXIT
- SERVICE BOOTH
- TOILET
- HALL ENTRY
- HALL EXIT
- COFFEE SHOPS
- INFORMATION KIOSK
- FIRST AID
- MOBILE CHARGING
- WATER STATION
- DIGITAL KIOSK
- CAFETERIA
- ELEVATOR
- ESCALATOR

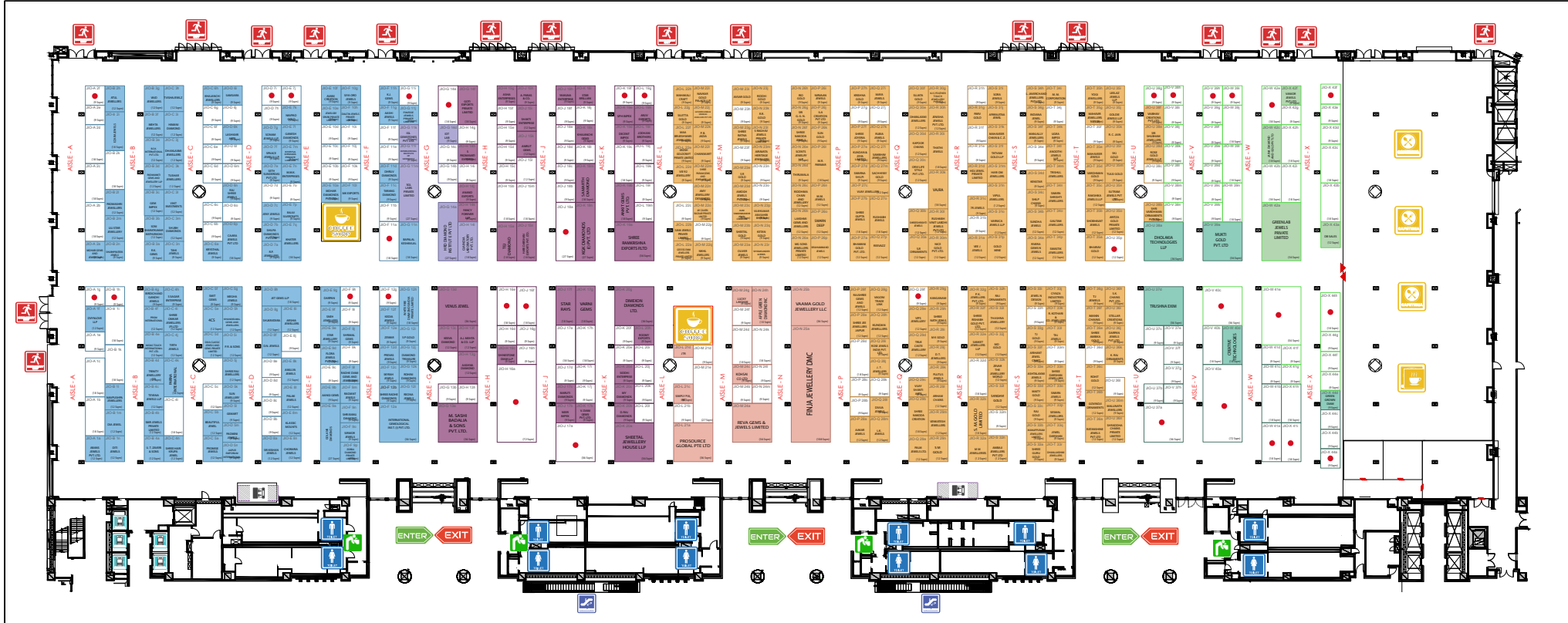

Disclaimer:

Installations designed for ambience and information kiosk will be created at the central squares (as marked) and the council retains the right to change the same without prior notice. The stalls around the central squares will not have unobstructed visibility as the installation will have varying heights. Aisle widths across the plan might vary due to sight constraints. Stalls around the central square peripheries will have a 3mt. minimum clear space from the stall boundaries.

Exhibitor are advised to select their stalls taking into consideration the locations and varying dimensions of columns, Pillar Cladding as marked in the plans. The plans provided are not to scale but are accurate as possible, however due to site constraints and ongoing site up-gradations minor variations and changes may occur. Council retains the right to make any necessary changes on the floorplan as necessitated by safety and regulatory requirements on site which all exhibitors are liable to strictly adhere to.

PREMIUM-

- CORNER LOCATION - 10%
- PREMIUM LOCATION - 15%
- ISLAND LOCATION - 15%